

THE INFORMATION HEREIN IS ALSO TO BE MAINTAINED AS A SECRET.

- A. Existing**
- Planting shall be set out as shown on the drawing, and existing trees shall be protected. Care shall be taken to ensure that the planting is done in accordance with the relevant codes and standards. The contractor shall ensure that the planting is done in accordance with the relevant codes and standards. The contractor shall ensure that the planting is done in accordance with the relevant codes and standards.
 - All existing trees shall be protected. Care shall be taken to ensure that the planting is done in accordance with the relevant codes and standards. The contractor shall ensure that the planting is done in accordance with the relevant codes and standards. The contractor shall ensure that the planting is done in accordance with the relevant codes and standards.
- B. Ground preparation**
- Providing landscape specification: Apply by the contractor to the relevant codes and standards. The contractor shall ensure that the planting is done in accordance with the relevant codes and standards. The contractor shall ensure that the planting is done in accordance with the relevant codes and standards.
 - Carrying out landscaping to the existing ground level: The contractor shall ensure that the planting is done in accordance with the relevant codes and standards. The contractor shall ensure that the planting is done in accordance with the relevant codes and standards.
 - Carrying out landscaping to the existing ground level: The contractor shall ensure that the planting is done in accordance with the relevant codes and standards. The contractor shall ensure that the planting is done in accordance with the relevant codes and standards.
- C. Planting**
- All planting shall be carried out in accordance with the relevant codes and standards. The contractor shall ensure that the planting is done in accordance with the relevant codes and standards. The contractor shall ensure that the planting is done in accordance with the relevant codes and standards.
 - No excavations shall be carried out without the prior approval of the relevant authorities. The contractor shall ensure that the planting is done in accordance with the relevant codes and standards. The contractor shall ensure that the planting is done in accordance with the relevant codes and standards.
 - Planting shall be carried out in accordance with the relevant codes and standards. The contractor shall ensure that the planting is done in accordance with the relevant codes and standards. The contractor shall ensure that the planting is done in accordance with the relevant codes and standards.
- D. Maintenance**
- All works shall be carried out in accordance with the relevant codes and standards. The contractor shall ensure that the planting is done in accordance with the relevant codes and standards. The contractor shall ensure that the planting is done in accordance with the relevant codes and standards.
 - All works shall be carried out in accordance with the relevant codes and standards. The contractor shall ensure that the planting is done in accordance with the relevant codes and standards. The contractor shall ensure that the planting is done in accordance with the relevant codes and standards.
 - All works shall be carried out in accordance with the relevant codes and standards. The contractor shall ensure that the planting is done in accordance with the relevant codes and standards. The contractor shall ensure that the planting is done in accordance with the relevant codes and standards.

EXISTING SPORTS CLUB



BM 33.86m

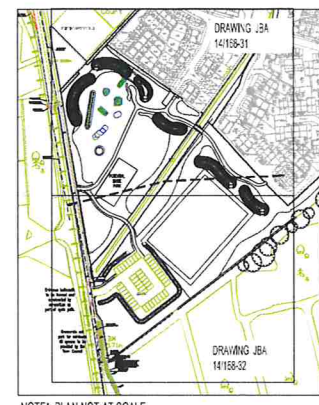

NOTE: FOR PLANT LIST SEE DRAWING NO. JBA 14/168-32

KEY

- PROPOSED STANDARD TREE, INCLUDING DOUBLE STAKE AND TIE. SEE SPECIFICATION NOTES A1, B2, B3, C1, C1.1, C1.2 AND C1.3.
- PROPOSED HEAVY STANDARD TREE, INCLUDING DOUBLE STAKE AND TIE. SEE SPECIFICATION NOTES A1, B2, B3, C1, C1.1, C1.2 AND C1.3.
- PROPOSED CONE EVERGREEN OR SHRUB PLANTING IN MASSES, INCLUDING NATIVE WIRP AND SHRUB PLANTING IN MASSES, INCLUDING BUCKINGHAM PALACE AND BUCKINGHAM PALACE SPECIFICATION, SEE SPECIFICATION NOTES A1, B2, B3, C1, C1.1, C1.2 AND C1.3.
- CULTIVATED TURF (UNLESS OTHERWISE STATED ON PLAN, SEE SPECIFICATION NOTES B1, C1 AND C1.1).
- WET WILDOFLOWER SEEDED AREA. REFER TO PLANT SCHEDULE FOR SPECIFICATION OF MIX.
- WILDOFLOWER SEEDED AREA. REFER TO PLANT SCHEDULE FOR SPECIFICATION OF MIX.
- BULB PLANTING IN MASSES, SPRING/FLOWERING VARIETIES. REFER TO SCHEDULE FOR FURTHER INFORMATION.
- SPECIMEN SHRUBS IN SHRUB BEDS OR TIE PLANTED IN CROSSING AREAS. SPECIMEN SHRUBS IN GRASS ARE MEASURED SEPARATELY IN SCHEDULE OF QUANTITIES. SEE SPECIFICATION NOTES A1, B1, C1, C1.1, C1.2 AND C1.3.
- EXISTING TREE TO BE RETAINED. SEE GENERAL NOTE A1 AND C1.1 IF PROPOSED. SEE ALSO JAMES BLAKE ASSOCIATES PLAN AND SCHEDULE FOR ANY SURVEY WORKS.
- EXISTING VEGETATION, GRASS OR HEDGE TO BE RETAINED. SEE GENERAL NOTE A1 AND C1.1 IF PREPARED. SEE ALSO JAMES BLAKE ASSOCIATES PLAN AND SCHEDULE FOR ANY SURVEY WORKS.
- BOSTON THREED LITTER BIR, B2S 400 TIE, AVAILABLE FROM FURNITURES INTERNATIONAL LTD TEL: 020 8378 3200 OR SIMILAR AND APPROVED BY THE LOCAL PLANNING AUTHORITY.
- TANMACHAN FOOTPATH WITHIN THE PUBLIC OPEN SPACE TO INCLUDE FLAT TOP EDGE TO THE STRAIGHT SECTIONS AND CONCRETE BLOCK EDGING (1.5M) STRONG COURSE TO CURVED SECTIONS. BLOCKS TO BE ALL SOING FLUSH WITH PAVING AND 150mm ABOVE ADJACENT GRASS AND BARK LEVELS.
- POST AND DOUBLE RAIL FENCE.
- POST AND WIRE FENCING, AS SHOWN.
- METAL DIVING HUT, AVAILABLE FROM PROLUIC.
- WALKWAY BRICKS, 150x150x50mm, AVAILABLE FROM PROLUIC.
- STEPPING STONES, AVAILABLE FROM PROLUIC.
- DRIGHN LOG WALK, 140x140mm, AVAILABLE FROM PROLUIC.
- DRIGHN LOG STEPPERS, 140x140mm, AVAILABLE FROM PROLUIC.
- GRASS SWALE, AVAILABLE FROM PROLUIC.
- METAL POND SWING, 140x140mm, AVAILABLE FROM PROLUIC.
- CAMBER TACK PAVEMENT, AVAILABLE FROM PROLUIC.
- METAL CAR PARK, 140x140mm, AVAILABLE FROM PROLUIC.
- LOW PLATFORM ROUNDABOUT, 140x140mm, AVAILABLE FROM PROLUIC.

NOTE: SEPARATE EXTERNAL LAYOUT DRAWINGS BY DEVELOPER FOR SPECIFICATION AND ARRANGEMENT OF FENCING AND OTHER HARDWORKS

NO.	DATE	DESCRIPTION
1	12/12/2012	ISSUE FOR PERMIT
2	12/12/2012	ISSUE FOR PERMIT
3	12/12/2012	ISSUE FOR PERMIT
4	12/12/2012	ISSUE FOR PERMIT
5	12/12/2012	ISSUE FOR PERMIT
6	12/12/2012	ISSUE FOR PERMIT
7	12/12/2012	ISSUE FOR PERMIT
8	12/12/2012	ISSUE FOR PERMIT
9	12/12/2012	ISSUE FOR PERMIT
10	12/12/2012	ISSUE FOR PERMIT

James Blake Associates
 HEAD OFFICE
 The Block, 148 Road, London, SW18 1JG
 Tel: 020 8748 1000 Fax: 020 8748 1001
 james@jamesblake.co.uk www.jamesblake.co.uk
 LANDSCAPE ARCHITECTURE • ARBORICULTURE • ECOLOGY

REPLACEMENT NOTES - PLANTING TO THE NEIGHBORHOOD SCHEDULE

1. All planting shall be done as shown on the drawings and measured from existing fast points. Curved beds will be set out on a grid pattern on the ground. The corner stakes shall be placed at 10m intervals along the curve. The curve shall be marked with a string line. The corner stakes shall be placed at 10m intervals along the curve. The curve shall be marked with a string line.
2. All planting shall be done as shown on the drawings and measured from existing fast points. Curved beds will be set out on a grid pattern on the ground. The corner stakes shall be placed at 10m intervals along the curve. The curve shall be marked with a string line. The corner stakes shall be placed at 10m intervals along the curve. The curve shall be marked with a string line.
3. All planting shall be done as shown on the drawings and measured from existing fast points. Curved beds will be set out on a grid pattern on the ground. The corner stakes shall be placed at 10m intervals along the curve. The curve shall be marked with a string line. The corner stakes shall be placed at 10m intervals along the curve. The curve shall be marked with a string line.

GENERAL NOTES FOR THE DEVELOPER:

1. The contractor shall be responsible for the removal of the existing vegetation and for the replacement of the vegetation to the satisfaction of the Council.
2. The contractor shall be responsible for the removal of the existing vegetation and for the replacement of the vegetation to the satisfaction of the Council.
3. The contractor shall be responsible for the removal of the existing vegetation and for the replacement of the vegetation to the satisfaction of the Council.

GENERAL NOTES FOR THE DEVELOPER:

1. The contractor shall be responsible for the removal of the existing vegetation and for the replacement of the vegetation to the satisfaction of the Council.
2. The contractor shall be responsible for the removal of the existing vegetation and for the replacement of the vegetation to the satisfaction of the Council.
3. The contractor shall be responsible for the removal of the existing vegetation and for the replacement of the vegetation to the satisfaction of the Council.

GENERAL NOTES FOR THE DEVELOPER:

1. The contractor shall be responsible for the removal of the existing vegetation and for the replacement of the vegetation to the satisfaction of the Council.
2. The contractor shall be responsible for the removal of the existing vegetation and for the replacement of the vegetation to the satisfaction of the Council.
3. The contractor shall be responsible for the removal of the existing vegetation and for the replacement of the vegetation to the satisfaction of the Council.

GENERAL NOTES FOR THE DEVELOPER:

1. The contractor shall be responsible for the removal of the existing vegetation and for the replacement of the vegetation to the satisfaction of the Council.
2. The contractor shall be responsible for the removal of the existing vegetation and for the replacement of the vegetation to the satisfaction of the Council.
3. The contractor shall be responsible for the removal of the existing vegetation and for the replacement of the vegetation to the satisfaction of the Council.

GENERAL NOTES FOR THE DEVELOPER:

1. The contractor shall be responsible for the removal of the existing vegetation and for the replacement of the vegetation to the satisfaction of the Council.
2. The contractor shall be responsible for the removal of the existing vegetation and for the replacement of the vegetation to the satisfaction of the Council.
3. The contractor shall be responsible for the removal of the existing vegetation and for the replacement of the vegetation to the satisfaction of the Council.

KEY

- PROPOSED STANDARD TREE INCLUDING DOUBLE STAKE AND TIE. SEE SPECIFICATION NOTES AT B3.3, B5.14, C14 AND E1.
- PROPOSED HEAVY STANDARD TREE INCLUDING DOUBLE STAKE AND TIE. SEE SPECIFICATION NOTES AT B3.3, B5.14, C14 AND E1.
- PROPOSED CORNER OR BROAD LEAF EVERGREEN TREE INCLUDING STAKE AND TIE. SEE SPECIFICATION NOTES AT B3.3, B5.14, C14 AND E1.
- NATIVE WIP AND SHRUB PLANTING MIXES INCLUDING BIODIVERSITY SHEET AND BARK MULCH (ACCORDING TO SPECIFICATION SEE SPECIFICATION NOTES AT B3.3, C14 AND E1).
- CULTIVATED TURF UNLESS OTHERWISE STATED ON PLAN. SEE SPECIFICATION NOTES AT B5 AND E1.
- WET W.L.D. COVER SEEDING AREA. REFER TO PLANT SCHEDULE FOR SPECIFICATION OF MIX.
- W.L.D. LOWER SEEDING AREA. REFER TO PLANT SCHEDULE FOR SPECIFICATION OF MIX.
- BULB PLANTING IN MIXES. SPRING FLOWERING VARIETIES. REFER TO SCHEDULE FOR FURTHER INFORMATION.
- SPECIMEN SHRUBS IN SHRUB BEDS OR PLANTED IN GRASS/PAVED AREAS. SPECIMEN SHRUBS IN GRASS ARE SEPARATELY SPECIFIED IN THE SCHEDULE OF QUANTITIES. SEE SPECIFICATION NOTES AT B3.3, C14, D14 AND E1.
- EXISTING TREE TO BE RETAINED. SEE GENERAL NOTE AT E1. IF PREPARED, SEE ALSO JAMES BLAKE ASSOCIATES PLAN AND SCHEDULE FOR ANY SURGERY WORKS.
- EXISTING VEGETATION GROUP OR HEDGE TO BE RETAINED. SEE GENERAL NOTE AT E1. IF PREPARED, SEE ALSO JAMES BLAKE ASSOCIATES PLAN AND SCHEDULE FOR ANY SURGERY WORKS.
- BOSTON TRIMMER LITTER BIN BOX 400 TB. AVAILABLE FROM FURNITURES INTERNATIONAL LTD TEL: 020 8276 3200 OR ONLINE AND APPROVED BY THE LOCAL PLANNING AUTHORITY.
- TERRAZZO/CLAM FOOTPATHS WITHIN THE PUBLIC OPEN SPACE TO INCLUDE FLAT TOP PCC EDGE (100mm) TO STRAIGHT SECTIONS AND CONCRETE 50mm FROGGING (150mm) TO CURVED SECTIONS. BLOOMS TO BE ALL EDGING FLASH WITH PAINTING 15mm ABOVE ADJACENT GRASS AND BARK LEVELS.
- POST AND DOUBLE RAIL FENCE
- POST AND WIRE FENCING AS BUILT
- METAL STAINLESS-STEEL AVAILABLE FROM PROLUCC
- MONEY BARS - UNPAID, AVAILABLE FROM PROLUCC
- STEPPING STONES - AVAILABLE FROM PROLUCC
- ORION LOG WALLS - UNPAID, AVAILABLE FROM PROLUCC
- ORION LOG STEPPERS - UNPAID, AVAILABLE FROM PROLUCC
- GRASS SWING, AVAILABLE FROM PROLUCC
- VITAL POD SWING - UNPAID, AVAILABLE FROM PROLUCC
- CLAMBER STACK PEGGOL - AVAILABLE FROM PROLUCC
- 100mm PLATFORM ROUNDABOUT - UNPAID, AVAILABLE FROM PROLUCC

NOTE: SEE SUPPLEMENTARY EXTERNAL LAYOUT DRAWINGS (BY DEVELOPER) FOR SPECIFICATIONS AND ARRANGEMENT OF FENCING AND OTHER HARD WORKS

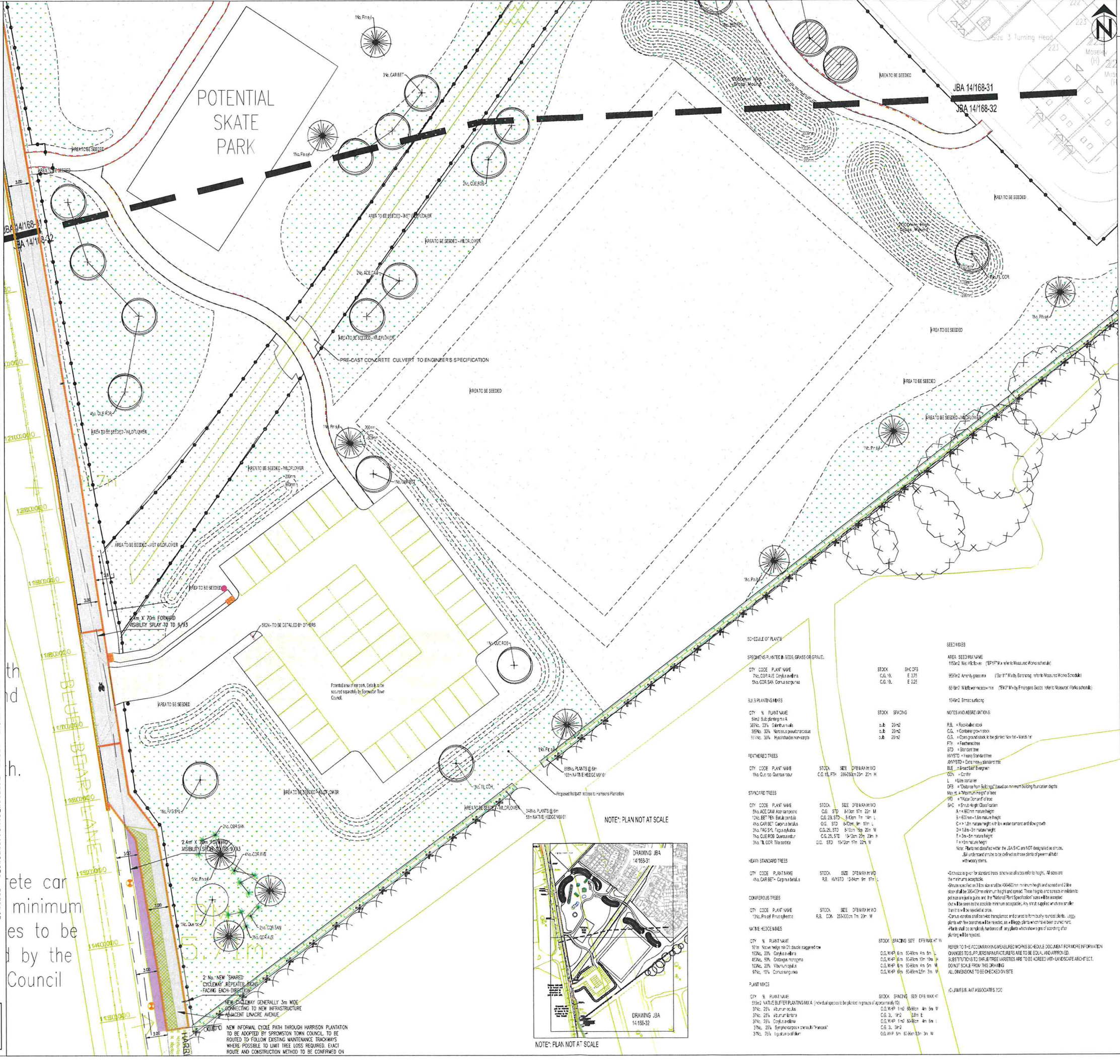

SCHEDULE OF PLANTS

PROVIDER/INTEGRATED GRASS OR GRAVEL	STOCK	SEE	DEMAN IN QTY
CITY CODE PLANT NAME	1000	100	100
1000	100	100	100

SHRUB PLANTING MIXES

CITY CODE PLANT NAME	STOCK	SEE	DEMAN IN QTY
1000	100	100	100
1000	100	100	100

FEATHERED TREES

CITY CODE PLANT NAME	STOCK	SEE	DEMAN IN QTY
1000	100	100	100
1000	100	100	100

STANDARD TREES

CITY CODE PLANT NAME	STOCK	SEE	DEMAN IN QTY
1000	100	100	100
1000	100	100	100

HEAVY STANDARD TREES

CITY CODE PLANT NAME	STOCK	SEE	DEMAN IN QTY
1000	100	100	100
1000	100	100	100

CONIFEROUS TREES

CITY CODE PLANT NAME	STOCK	SEE	DEMAN IN QTY
1000	100	100	100
1000	100	100	100

WIRE-HEDGEABLES

CITY CODE PLANT NAME	STOCK	SEE	DEMAN IN QTY
1000	100	100	100
1000	100	100	100

PLANT MIXES

CITY CODE PLANT NAME	STOCK	SEE	DEMAN IN QTY
1000	100	100	100
1000	100	100	100

SEED MIXES

AREA	SEED NAME	QUANTITY
1000	1000	1000
1000	1000	1000

NOTES AND ABBREVIATIONS

- R.B. = Random seed
- C.G. = Combined grass
- C.S. = Combined seed
- F.H. = Feeder mix
- S.T. = Standard tree
- H.V.T. = Heavy Standard tree
- A.P.T. = Area Planting tree
- C.S. = Combined seed
- C.S. = Combined seed

REVISIONS

NO.	DATE	BY	REVISION
1	10/10/20	JBA	ISSUED FOR TENDERS
2	10/10/20	JBA	ISSUED FOR TENDERS

DATE: 10/10/20
BY: JBA
SCALE: 1:200
PROJECT: HARRISON PLANTATION
DRAWING NO: 14/168-32
CLIENT: HARRISON PLANTATION
DESIGNER: JAMES BLAKE ASSOCIATES

HEAD OFFICE:
 1000 South Street, London, Surrey, Surrey, Surrey
 Tel: 01753 242124
 www.jamesblakeassociates.co.uk

